

the **HAMWORTHY**

BRAZED PLATE HEAT EXCHANGER

60kW

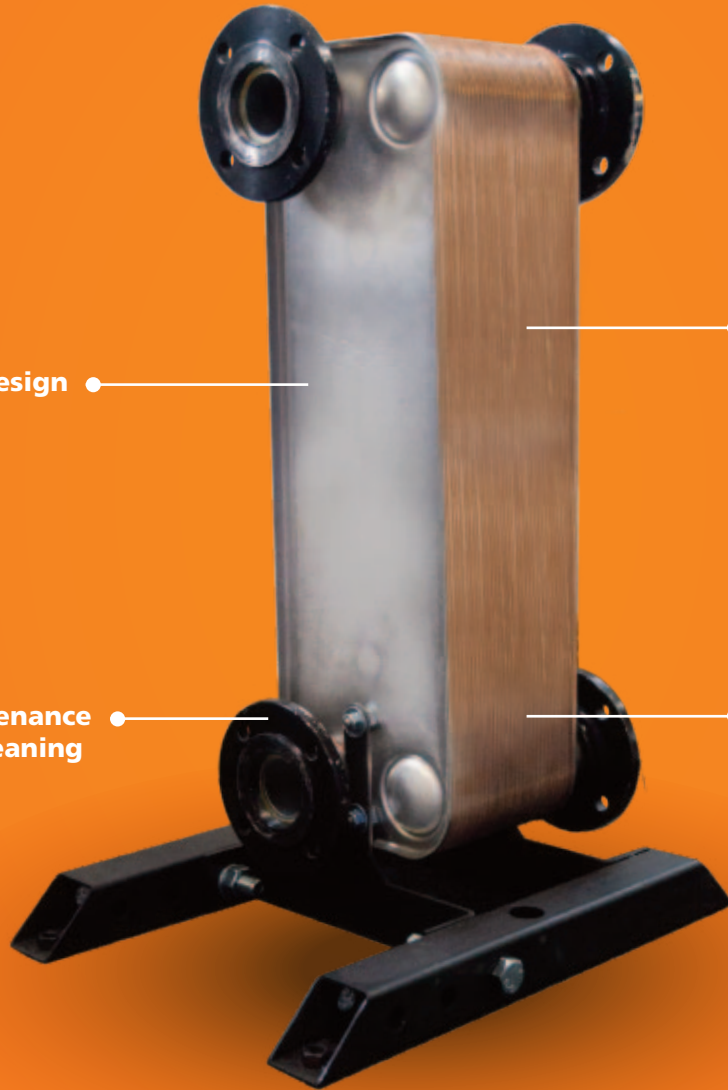

Compact design

Separates system water from the boiler

Low maintenance and self-cleaning

Used with Hamworthy Heating Cascade kits



SCAN ME

[hamworthy-heating.com](https://www.hamworthy-heating.com)
sales@hamworthy-heating.com | 01202 662500



Technical submittal

Products: **Brazed Plate Heat Exchanger – 60kW**

Project:

Customer:

Date:

60kW is the nominal capacity of the plate heat exchanger applying the operating conditions shown below. Please contact Hamworthy Heating to confirm the expected performance if the operating conditions differ from those shown.

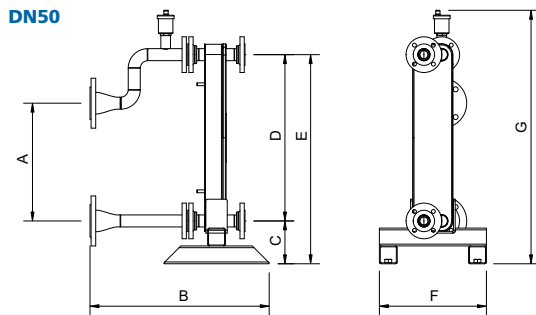

Dimensions

Dimension	A	B	C	D	E	F	G
DN50	330	502	120	466	586	300	710

	UNITS	HOT SIDE	COLD SIDE
Mass flow rate	kg/s	0.72	0.72
Inlet temperature	°C	80	50
Outlet temperature	°C	60	70
Pressure drop	kPa	14.0	19.3
Heat exchanged	kW	60	
Heat transfer area	m ²	1	
Flow configuration	Countercurrent		
Number of plates / thickness	20 / 0.3 mm		
Number of passes		1	1
Pressure vessel code	PED		
Design pressure at 90.00 Celsius	Bar	40	40
Design pressure at 225.0 Celsius	Bar	32	32
Design temperature	°C	-196.0 / 225.0	
Overall length x width x height	mm	139 x 113 x 527	
Volume	L	1.0	0.9
Net weight, empty / operating	kg	5.8 / 7.7	

Standard Materials

Cover plates	Stainless steel
Connections	Stainless steel
Plates	Stainless steel
Brazing	Copper

PLEASE NOTE:
The plate heat exchangers are to be used for system separation only.
They must not be used for the direct production of domestic hot water.

They should not be used for direct heating of swimming pool water where the chlorinated pool water would pass directly through the plate heat exchanger.

Connections

FRAME & HEADER

Stratton mk3	DN50	DN80	DN100
	✓		
System			
DN25			
Flanged			
PN6			