

O'Pro Turbo

WATER HEATER EQUIPPED WITH O'PRO PROTECTION
AND HIGH-OUTPUT HEATING ELEMENT PROVIDING FASTER HEAT-UP TIME



+ PRODUCT

COMFORT

- Fast heat-up time thanks to 2500 W or 3000 W heating element (heating water up to 30% faster)
- Frontal control knob for the most accurate temperature control
- Flat chromed thermometer

QUALITY - DURABILITY

- Long tank lifetime thanks to O'Pro exclusive anti-corrosive system
- Magnesium anode for strengthened tank protection
- New generation diamond-quality enamel (glass-lined inner tank)
- Pressure relief valve
- Dielectric union
- Specific lip gasket to avoid corrosion around flange

USER-FRIENDLINESS

- IP 24 - full compliance with European standards for electrical safety and user protection
- Plug*
- Heating light indicator

SAVINGS

- High-precision bulb thermostat with integrated security for accurate controls
- High-efficiency water inlet
- CFC-free high-density insulation for more energy savings

ELECTRIC WATER HEATER

50 TO 100 L (VERTICAL WALL-MOUNTED)

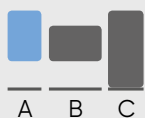

Model available**



More hot water



Frontal control knob



Tank protection

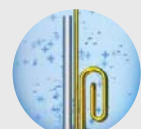

Copper heating element

O'Pro Turbo

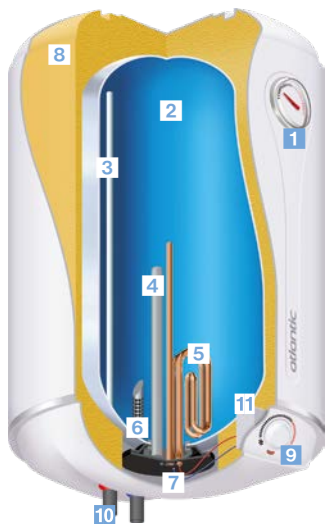

- 1 External thermometer
- 2 Diamond-quality enamel (glass-lined inner tank)
- 3 Optimised stainless outlet pipe
- 4 Magnesium anode
- 5 Sheathed immersion heating element
- 6 Inlet diffuser
- 7 O'Pro anti-corrosive system
- 8 High-density polyurethane foam 0% CFC
- 9 Frontal control knob
- 10 Dielectric union
- 11 Thermostat

O'Pro exclusive anti-corrosive system balances out the electrical potential of the tank and immersion heating element. Thus, the magnesium anode life is considerably increased and protection against corrosion is reinforced.

INSTALLATION DIMENSIONS

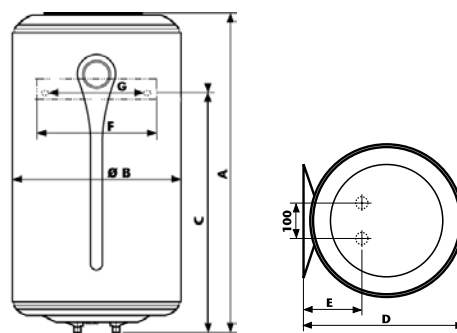

TECHNICAL DATA

| CAPACITY (L) | OUTPUT (W) | VOLTAGE (V) | ENERGY CONSUMPTION (kWh/24 h AT 65°C) | HEAT-UP TIME AT 60°C (ΔT=50°C) |
|--------------|------------|---------------|---------------------------------------|--------------------------------|
| 50 | 2500/3000 | 230 (220/240) | 0.95 | 1h08/0h57 |
| 80 | 2500/3000 | 230 (220/240) | 1.35 | 2h01/1h41 |
| 100 | 2500/3000 | 230 (220/240) | 1.70 | 2h30/2h05 |

DIMENSIONS

| CAPACITY (L) | DIMENSIONS (mm) | | | | | | | FLANGE OPENING (Ø) mm | NET WEIGHT (Kg) | ERP ENERGY CLASS | PROFILE |
|--------------|-----------------|-----|-----|-----|-----|-----|-----|-----------------------|-----------------|------------------|---------|
| | A | B | C | D | E | F | G | | | | |
| 50 | 629 | 433 | 395 | 451 | 158 | 300 | 239 | 72 | 15 | C | M |
| 80 | 876 | 433 | 605 | 451 | 158 | 300 | 239 | 72 | 21 | C | L |
| 100 | 1038 | 433 | 755 | 451 | 158 | 300 | 239 | 72 | 24 | C | L |